

# Heart of l'Eixample

Recommended by  
Like Living There<sup>SM</sup>

Wonderful location for a couple, small family or business traveler. On a high floor and the same block as Gaudi's La Pedrera (Casa Milà) at the top of Passeig de Gràcia. Panoramic windows on two streets add to the effect. The Paseo itself is filled with restaurants and shopping, from high-end boutiques to the flagship Zara store.

To reach the rest of the city there is a choice of four Metro lines at two nearby stations.



**Size:** 50 square meters. European fifth floor with elevator. Up to 4 persons.

**Bedroom:** One with double bed, nightstand, closet.

**Bathroom:** Full, with shower, toilet, hair dryer.

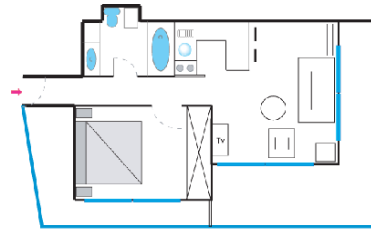

**Living/dining:** Sleeper sofa, chair, dining counter.



**Kitchen:** Modern and fully equipped with microwave, refrigerator, freezer, coffee-maker, pots and pans, cutlery, etc.



**Communications:** Color television, DVD, high-speed internet.

**Other:** Panoramic windows, terrace.

**Rates:** 120€ per night for two, 20€ each additional person. No cleaning fee. Credit cards accepted.

[Click for Google map](#)   [Check Availability](#)

## Nearby

Left: La Concepció is known for its flowers but is a complete fresh market with a grocery in the lower level.

Center: Interior of Gaudi's Sagrada Familia.

Below: Open-air dining on Passeig de Gràcia.

